

SIZE	MODEL
1/2"	905T
3/4"	907T
1"	910T
1 1/4"	912T
1 1/2"	915T
2"	920T
2 1/2"	925T
3"	930T
3 1/2"	935T
4"	940T
5"	950T

**STYLE 20**

**STYLE 30**

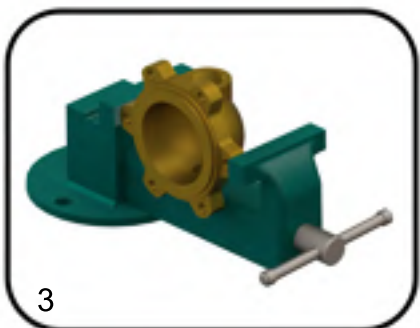

1. First hold the housing of the joint with a bench vise. Do not clamp too tightly, it will damage housing or bearings.

2. Apply sealant or teflon tape to the thread of the inlet hose and assemble it to the housing inlet.

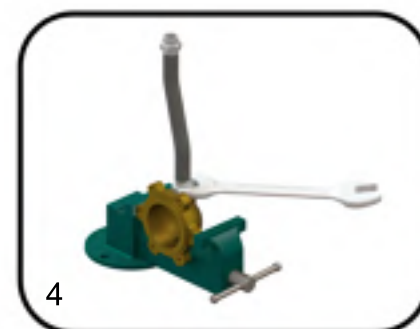

3. Hold the end cap of the joint with the bench vise. Do not clamp too tightly, it will damage end cap.

4. Apply sealant or teflon tape to the thread of the outlet hose and assemble it to the end cap.



5. Clean machine bore surface before assembling.

6. As the internal siphon pipe is with the machine; first apply grease around the surface of the siphon pipe nose.

7. Apply sealant or teflon tape to the thread of the shaft, place the joint around the siphon pipe and install the joint to the machine. When installing, pay attention not to install eccentrically. Also be careful not to damage internal parts and siphon pipe packing.

8. If the joint shaft is quick release; put a new copper washer on the bore of the roll, assemble qr flange onto the shaft, place split rings onto the socket around the shaft correspondingly, place qr flange onto the split wedges and fix the flange to the bore of the roll with appropriate bolts.





9. Place a new copper gasket onto the assembly plate and assemble the end cap onto the copper gasket. Fix the end cap to the housing with appropriate bolts.



10. Connect hoses to the supply and return lines. Use flexible hoses and never install joint directly to the pipes.

11. Assemble hoses without sharp bends or without stress. Rotary joints are designed to float with the hoses.

12. For water and steam use stainless steel flexible hoses.

13. Install hoses with curves in direction of rotation.

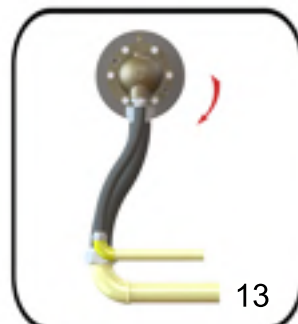

14. Flexible hoses must not be twisted during operation. Twisted hoses lose flexibility. Use pipe fittings for proper installation.

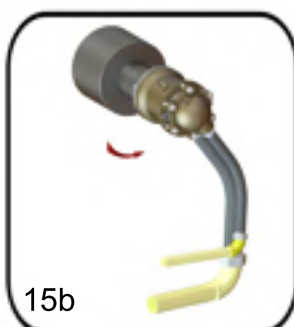
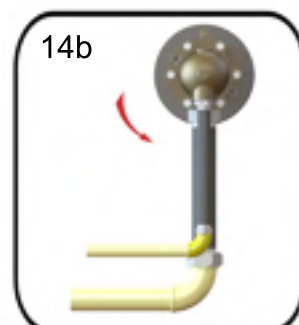
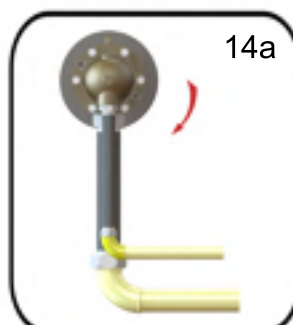

15. If rotating joint and pipe axis are not on the same axis, hose must be installed with a smooth curve.

16. Flexible hoses must not be twisted during operation. Use proper pipe fittings.

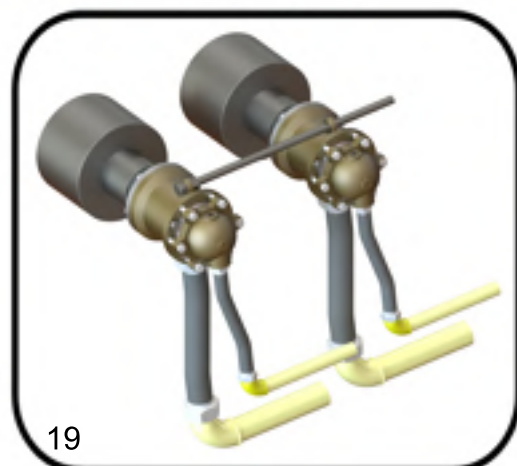

17. After assembly; control rotation of joint. If any noise, wobble, vibration, knocking or noise show up or if any eccentricity seems; disassemble the joint from the machine and assemble it again.

18. All 900P Series housings have an anti rotation lug on the housing which is used to stop the housing from rotation.

19. Install the anti rotation rod into the hole on the lug on the housing. Never tie more than 2 joints with a single rod. Fix the rod to one of the holes of the joints and leave the rod to float.