

SIZE	MODEL
1/2"	905S
3/4"	907S
1"	910S
1 1/4"	912S
1 1/2"	915S
2"	920S
2 1/2"	925S
3"	930S
4"	940S
5"	950S

STYLE 20



STYLE 50



STYLE 30/40



STYLE 60



1a

1. First hold the housing of the joint with a bench vise. Do not clamp too tightly, it will damage housing or bearings.

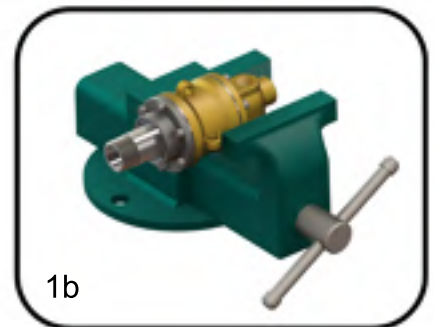

1b



2

2. If the joint is single flow, apply sealant or teflon tape to the thread of the inlet hose and assemble it to the end cap.

3. If the joint is used for dual flow,

3.a) For S type joints; apply sealant or teflon tape to the thread of the siphon pipe and place it inside the shaft and fix it to the end cap.

3.b) For Rsp type joints; siphon pipe is on the machine; apply grease around bearing surface of the siphon pipe.

3.c) Apply sealant or teflon tape to the thread of the inlet hose and assemble it to the end cap

3.d) Rotate joint upside down and hold it with the bench vise

3.e) Apply sealant or teflon tape to the thread of the outlet hose and assemble it to the end cap.

4. Clean machine bore surface before assembling.

5a. For S Type Joints; Apply sealant or teflon tape to the thread of the shaft and install the joint to the machine.

5b. For RSP Type Joints; For RSP type joints; place the joint around the siphon pipe and install the joint to the machine.

5c. When installing, pay attention not to install eccentrically.



3a/b

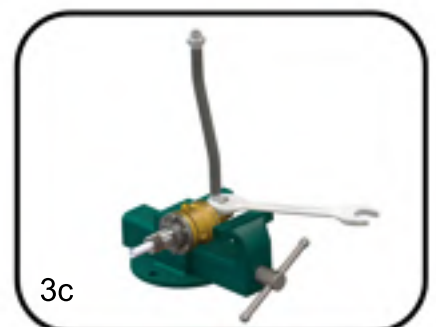

3c



5a

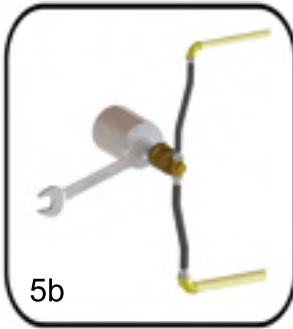

5b

6. If the joint shaft is quick release; put a new copper washer on the bore of the roll, assemble qr flange onto the shaft, place split rings onto the socket around the shaft correspondingly, place qr flange onto the split wedges and fix the flange to the bore of the roll with appropriate bolts.

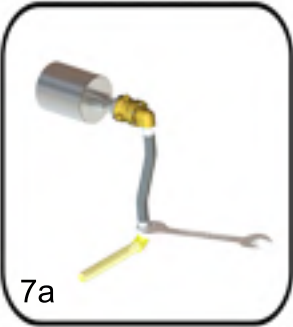

7a

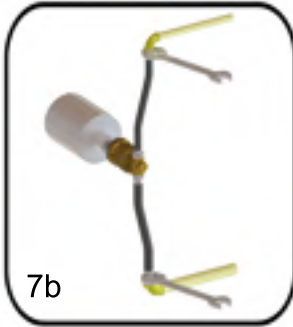

7b

7. Connect hoses to the supply and return lines. Use flexible hoses and never install joint directly to the pipes.

8. Assemble hoses without sharp bends or without stress. Rotary joints are designed to float with the hoses.

9. For water and steam, use stainless steel flexible hoses.



10

10. Install hoses with curves in direction of rotation.

11. Flexible hoses must not be twisted during operation. Twisted hoses lose flexibility. Use pipe fittings for proper installation.

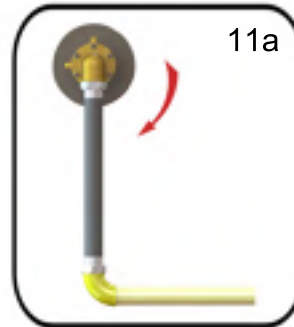

11a



11b

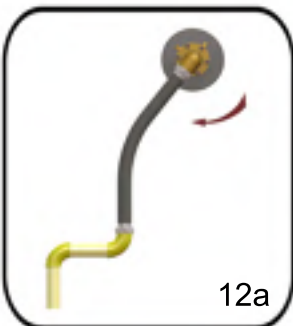

12a

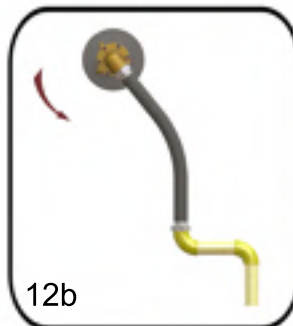

12b

12. If rotating joint and pipe axis are not on the same axis, hose must be installed with a smooth curve.

13. Flexible hoses must not be twisted during operation. Use proper pipe fittings.

14. After assembly; control rotation of joint. If any noise, wobble, vibration, knocking or noise show up or if any eccentricity seems; disassemble the joint from the machine and assemble it again.

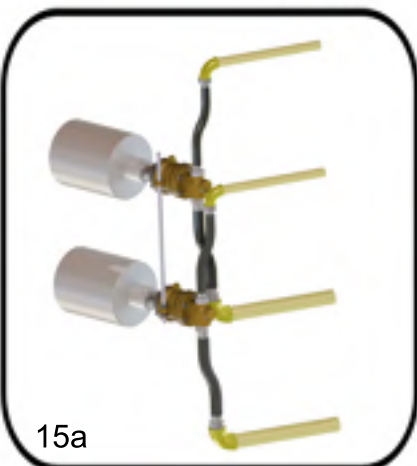

15a

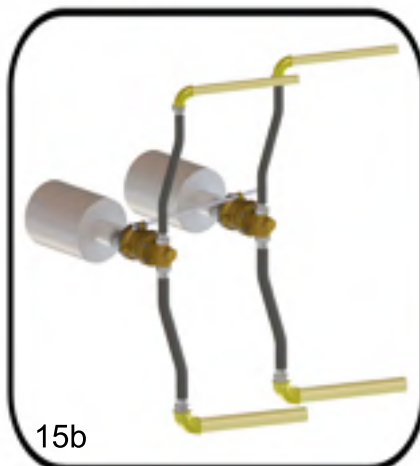

15b

15. All 900S Series housings have 1 anti rotation lug on the housing which is used to stop the housing from rotation.

16. Install the anti rotation rod into hole on the lug of the housing. Never tie more than 2 joints with a single rod. Fix the rod to one of the holes of the joints and leave the rod to float.