



5000 SERIES

SIZE: 2" (DN50) - 8" (DN200)

ASSEMBLY INSTRUCTIONS:

- 1.5000 Series swivel joints are designed for articulated motion only. Do not use for continuous rotation.
- 2.5000 Series swivel joints are assembled with different configuration of seals for different applications. For optimum seal performance according to your application, please consult factory.
- 3.5000 Series swivel joints are designed for max. temperature (-50°C) - (250°C) / (-58°F) - (437°F).
- 4.5000 Series swivel joints; steel models can be used upto 40 bar(580psi).

ASSEMBLY

- 1.Becareful not to apply force on the housing when assembling swivel joint to the system.
- 2.Before assembling the joint to the piping system, check pipe eccentricity. Pipe eccentricity may cause deformation on the weld sections and ball bearing races.
- 3.After assembly check if the swivel joint rotates smoothly without eccentricity.

MAINTENANCE

- 1.Unless otherwise stated, all 5000 Series swivel joints are lubricated before shipment. After disassembly and maintenance of the ball bearings, swivel joint must be lubricated. High temperature greases are suggested when high temperature medium will be used. Always check lubrication of the ball bearings before assembly.
- 2.5000 Series swivel joints do not need to be disassembled from the system for seal change.
- 3.For maintenance of 5000 Series on the system, refer to maintenance instructions.

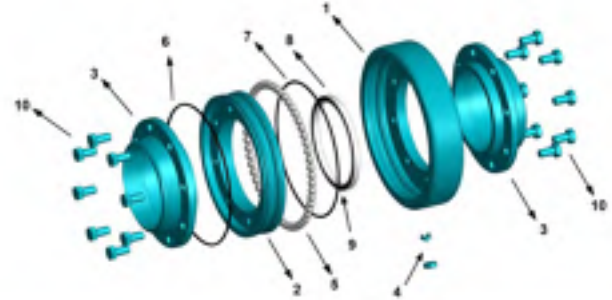

5000 SERIES SPARE PARTS LIST

1	5000 SERIES HOUSING	1
2	5000 SERIES SHAFT	1
3	5000 SERIES HOUSING FLANGE	2
4	BALL PLUG	1
5*	BALL BEARING	X
6*	O-RING	1
7*	O-RING	1
8*	SEAL RING	1
9*	O-RING	2
10	BOLTS	X

* Spare parts set