



900R SERIES INSTALLATION, OPERATION AND MAINTENANCE INSTRUCTIONS



Document No: TL 7 82 EN

Release Date: 01.01.2015

Rev No: 0

SIZE	MODEL
1/2"	905R
3/4"	907R
1"	910R
1 1/4"	912R
1 1/2"	915R
2"	920R
2 1/2"	925R
3"	930R
3 1/2"	935R
4"	940R
5"	950R

STYLE 20



STYLE 30



STYLE 40



STYLE 50



STYLE 60



WARNING

Unless specified; ROTOFLUID rotary joints must not be used with Hydrocarbons or Flammable Mediums. Leaking may result explosion or fire.

Medium: Steam, Hot Oil, Water

Max. Steam Pressure: 17 bar (250 psi)

Max. Hot Oil Pressure: 10 bar (150 psi)

Max. Temperature: 200°C (392°F) (900R Series)
315°C (600°F) (900R-H Series)

Max. Speed: 200 RPM

- Do not work with max. pressure at max. speed.
- All ROTOFLUID products are leakage tested before shipment. Disassembling or dismantling the joint invalidates the warranty.
- Operator should not make any modification or attachments and retrofitting of the rotary joint without manufacturers' consent is prohibited.
- It is important to use correct hand of rotary connection thread to ensure the Rotary Joint will not unscrew. If shaft rotates forward & reverse; flanged connection is recommended.
- ROTOFLUID Rotary Joints may only be installed by personel who have experience and knowledge about rotary joints and plumbing systems.
- For safe operation only use genuine ROTOFLUID parts.
- For safe operation only use hoses which are appropriate for the media.
- Follow engineering specifications of the machine builder.
- 900R Series Rotary Joints are designed to work with the interpassing medium. Do not run dry very long time. If application needs dry running, please consult factory.
- 900R Series shafts have a seal wear indicator which show up when the seal ring is worn %75.

INSTALLATION

- Do not connect Rotary Joint directly to piping. Rotary Joints are designed to float with the flexible hoses.
- Install hose with curve in direction of rotation.
- 900R Series Rotary Joints are shipped with different end caps according to application styles; single flow, dual flow s type or dual flow rsp type.
- Always flood the Rotary Joint and purge any entrapped air in the system before operating the machine to improve joint performance and longer joint life.
- 900R Series Rotary Joints are equipped with carbon seals. Because of the seal wear, shaft is pushed out of the housing by the spring force and the length of the joint will increase which must be allowed by the design of the machine or system.

For Style 20;

1a) First hold the housing of the joint with a bench vise. Do not clamp too tightly, it will damage housing or bearings.

1b) Apply sealant or teflon tape to the thread of the inlet hose and assemble it to the housing inlet.

For Styles 30-40;

2a) First hold the housing of the joint with a bench vise. Do not clamp too tightly, it will damage housing or bearings.

2b) Apply sealant or teflon tape to the thread of the siphon pipe and place it inside the shaft and fix it to the end cap.

2c) Apply sealant or teflon tape to the thread of the inlet hose and assemble it to the housing inlet.

2d) Rotate housing in order to assemble the outlet hose and hold it with the bench vise.

2e) Apply sealant or teflon tape to the thread of the outlet hose and assemble it to the end cap inlet.

For Style 50-60;

3a) First hold the housing of the joint with a bench vise. Do not clamp too tightly, it will damage housing or bearings.

3b) Apply sealant or teflon tape to the thread of the inlet hose and assemble it to the housing inlet.

3c) Hold the end cap of the joint with the bench vise. Do not clamp too tightly, it will damage end cap.

3d) Apply sealant or teflon tape to the thread of the outlet hose and assemble it to the end cap inlet.

4a) Apply sealant or teflon tape to the thread of the shaft and install joint to the machine. When installing, pay attention not to install eccentrically.

4b) If the joint shaft is quick release; put a new copper washer into the bore of the roll, assemble qr flange onto the shaft, place split rings onto the socket around the shaft correspondingly, place qr flange onto the split wedges and fix the flange to the bore of the roll with appropriate bolts.

5) 900R Series doesn't have carbon bearings. Be careful to align the rod holes on the housing to the rods on the machine. 900R Series are guided with the rods.

For style 50-60;

6) Place a new copper gasket onto the assembly plate and assemble end cap onto the copper gasket and fix it with appropriate bolts.

7) Connect hoses to the supply and return lines. Use flexible hoses and never install joint directly to the pipes.

8) Assemble hoses without sharp bends or without stress. Rotary joints are designed to float with the hoses.

9) For water and steam, use stainless steel flexible hoses.

10) Install hoses with curves in direction of rotation.

11) Flexible hoses must not be twisted during operation. Twisted hoses lose flexibility. Use pipe fittings for proper installation.

12) If rotating joint and pipe axis are not on the same axis, hose must be installed with a smooth curve.

13) Flexible hoses must not be twisted during operation. Use proper pipe fittings.

14) After assembly; control rotation of joint. If any noise, wobble, vibration, knocking or noise show up or if any eccentricity seems; disassemble the joint from the machine and assemble it again.

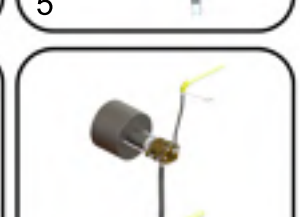
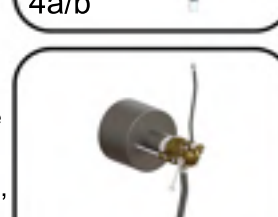
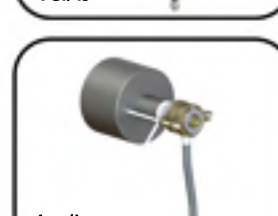
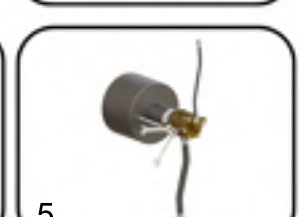
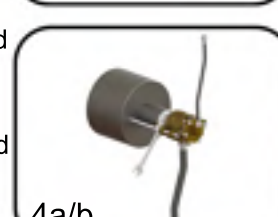
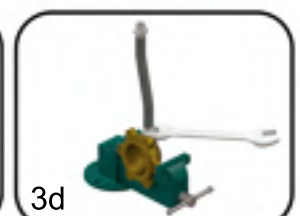
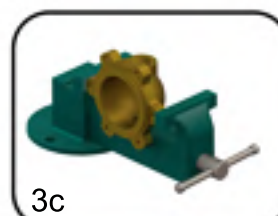
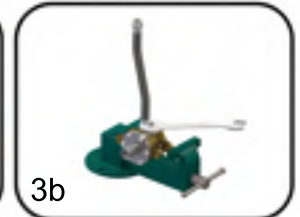
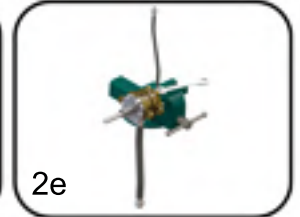
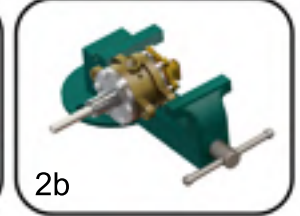
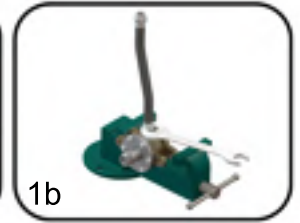
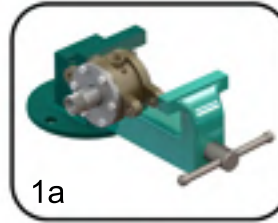

900R SERIES SPARE PARTS

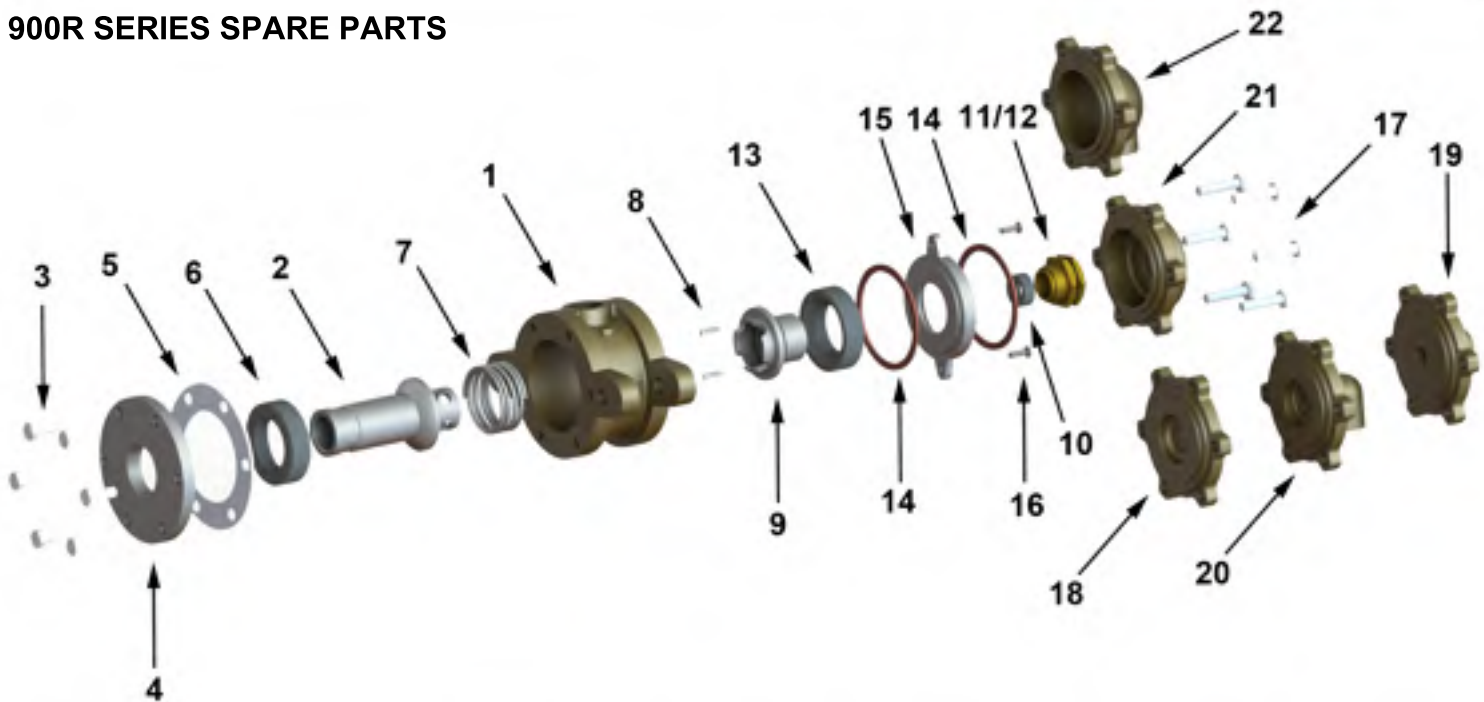

NO	PART NAME	QTY
1	HOUSING	1
2	SHAFT	1
3	BOLTS	n
4	FRONT HOUSING FLANGE	1
5	HOUSING GASKET	1
6	SEAL RING	1
7	SPRING	1
8	WEDGES	2
9	THRUST WASHER	1
10	SIPHON PACKING	n
11	PACKING GLAND	1

NO	PART NAME	QTY
12	LOCK NUT	1
13	SEAL RING	1
14	HOUSING GASKET	1
15	ASSEMBLY FLANGE	1
16	SCREWS	2
17	BOLTS	n
18	END CAP - STYLE 20	1
19	END CAP - STYLE 30	1
20	END CAP - STYLE 40	1
21	END CAP - STYLE 50	1
22	END CAP - STYLE 60	1

- n changes according to size of the joint
 - No:10-11-12 is only for RSP models

SPARE PARTS SET

- (5) Housing Gasket
- (6) Seal Ring
- (7) Spring
- (10) Siphon Packing
- (13) Seal Ring
- (14) Housing Gasket

Repair kits are available for 900R Series and can be supplied by ROTOFLUID.

If you don't want to repair your rotary joints, ROTOFLUID will disassemble the joints, clean and replace worn out parts and all sealing test will be made and joints will be shipped as good as a new joint.