



# B SERIES INSTALLATION, OPERATION, MAINTENANCE INSTRUCTIONS



Document No: TL 7 25 EN

Release Date: 17.06.2013

Rev No: 0

## B SERIES

**SIZE: 3/8" (DN10) - 2" (DN50)**

### ASSEMBLY INSTRUCTIONS:

- 1.B Series ball joints are designed for articulated motion only. Do not use for continuous rotation.
- 2.B Series ball joints allow piping systems to move in 2 or more planes.
- 3.B Series ball joints allow piping system  $\pm 15^\circ$  angular movement.
- 4.B Series ball joints return to central position with the help of the spring inside.
- 5.B Series ball joints are assembled with different configuration of seals for different applications. For optimum seal performance according to your application, please consult factory.
- 6.B Series ball joints are designed for max. 24 bar (350psi).
- 7.B Series ball joints have max. 220 °C / (430°F) temperature rating.

### ASSEMBLY

- 1.Always assemble housing connection first.
- 2.Becareful not to apply force on the housing when assembling the ball joint to the system.
- 3.For weld end models; do not allow heat and fire on the joint when assembling the ball joint to the system.
- 4.Check smooth rotation of the ball joint after assembly. If any eccentricity is seen, disassemble the joint and assemble it again.

### MAINTENANCE

- 1.Unless otherwise stated, B Series ball joints do not need lubrication.
- 2.As sealing is assured between shaft/seal ring; when doing maintenance seal ring must be changed and shaft sealing surface must be inspected against deformation.
- 3.If any leakage is seen, ball joint must be disassembled from the system and all worn out parts must be changed. Never use a leaking ball joint.

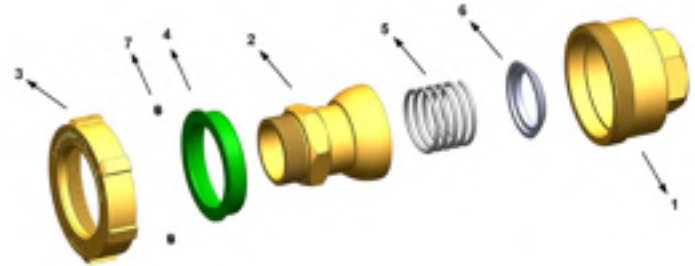

### B SERIES SPARE PARTS LIST

1	B SERIES HOUSING	1
2	B SERIES SHAFT	1
3	B SERIES NUT	1
4*	SEAL RING	1
5*	SPRING	1
6	SPRING SEAT	1
7	CAP SCREW	2

\* Spare parts set